

# CLS-740 Quick Guide

## 1. Please read below introduction carefully before using

WINYCAM CLS-740

1. Please check any defects on the product before installation. We are not responsible for any cost or expense incurred, as a result of the failure to check before installation.
2. If the constant power discharge protection function is set 'ON', motion detection will work as parking REC mode. If the car battery voltage becomes lower than setting value of cut off voltage, a recording will stop even parking REC mode.
3. We shall not take any responsibility for loss and damage of the device if used with other Micro SD card.
4. In case of an accident, be sure to turn off the product and remove the SD card from the product and save the accident video file to the PC. We are not responsible for the deleted parts of the files.

## 2. LED Guide

WINYCAM CLS-740

Item	Front LED	Rear LED				
		POWER LED		GPS LED (Blue)		
		Red	Green	NO GPS	GPS OFF	GPS ON
Booting	ON	ON	OFF	ON		
F/W update	0.25sec ON/ 0.25sec OFF	ON	OFF	ON		
Continuous REC (N)	1sec ON/ 1sec OFF	ON	OFF	OFF	1sec ON/ 1sec OFF	ON
Event REC (E)	Quickly ON/ OFF repeat	1sec ON/ 1sec OFF	OFF			
Parking REC (P)	ON	ON	OFF			
Parking REC standby	OFF	ON	OFF			
Wi-Fi ON	-	1sec ON/ 1sec OFF	1sec ON/ 1sec OFF			

## 3. Package

WINYCAM CLS-740

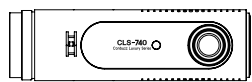

Main Body (CLS-740)



Bracket

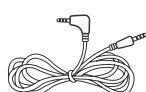

Rear Camera Cable

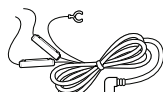

Hardwire Cable

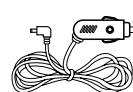

Cigar Lighter Cable

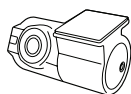

Rear Camera



Micro SD card & Adaptor

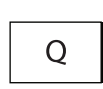

Quick Manual



GPS Module

### Option

## 4. Installation

WINYCAM CLS-740

### Front Camera Installation

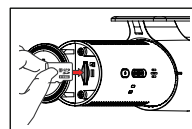

1. Insert Micro SD card to the slot of the device. (check the any faulty of the SD card)

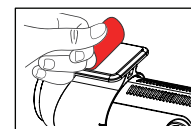

2. Remove the protection film from the bracket's tape.

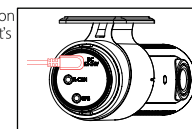

3. Connect the Hardwire cable to DC-IN port.

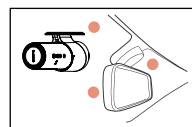

4. Attach the bracket at the left which from the windshield.



5. Connect the Hardwire cable into car fuse box.

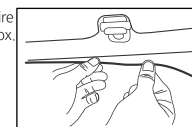

6. After checking the device, clean up the cables.



Please make sure to insert the hardwire cable to exact fuse box terminal. Some vehicles fuse terminal locations are different types. (Some vehicles may be blocked within minutes due to vehicle characteristics.)

※Please refer to the user manual of our website([www.winycam.com](http://www.winycam.com)) for details of assembly and disassembly of the brackets.

### Rear Camera Installation

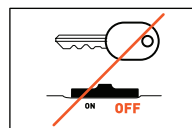

1. Please power off the car before installation. (disconnect the power connection)

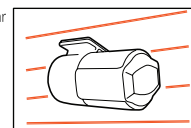

2. Remove the protection film of the bracket and attach the Camera in the proper location.

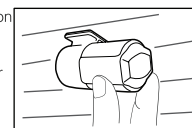

3. Adjust the camera angle and fix it. (To adjust the angle, the horizon is seen above the right center of the screen.)

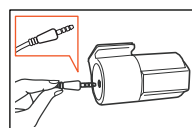

4. Plug (-) shape's rear end of the plug to the camera connection, (∩) shape's one to the device. (※caution※ Please note that if the wrong connection, the video will not be output.)

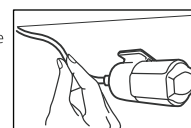

5. Arrange the wire by using the cable clip. (Please be careful not to drop or damage the cable during installation.)



While recording a video, the device may be affected by wireless devices such as radio frequency, DMB signal, remote start device, remote controller etc. Install as far away from the antenna and antenna cable as possible; and when cabling or tidying up cables, please avoid the cables to be duplicated.

### External GPS Installation

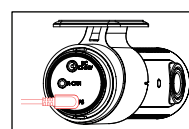

- Connect the external GPS to GPS port on the device terminal.

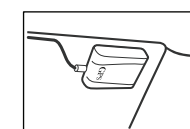

- Attach the external GPS into appropriate place, and tidy up the cable.



This feature may not be available in some countries. Other electronic devices may interfere with GPS signal if placed too close to the device. Keep its distance from them as much as possible. GPS may be affected by weather conditions, satellite signal, or surrounding geographical features. Coated windshields can interfere with GPS signal which may result in poor or blocked GPS reception.

# CLS-740 Quick Guide

## 5. How to use Multi-Key

1. AUDIO ON/OFF
2. WLAN(Wi-Fi) ON/OFF
3. Factory reset
4. Language selection

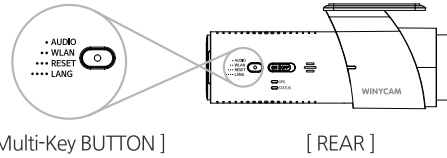

[ Multi-Key BUTTON ]

[ REAR ]

Press and hold the button for a certain period of time to start.

Time	Action	Remark
3sec	"Ding dong" alert 1 time, Press and release the button recording (mute) ON/OFF	The default is Wi-Fi OFF status with Factory released. It can change the status with a button action. If there is no use Wi-Fi for 15 minutes while Wi-Fi ON, Wi-Fi is automatically turned OFF.
3sec ~ 6sec	"Ding dong" alert 2 times, Wi-Fi ON/OFF	
6sec ~ 9sec	If you press 3 more times the button, it will be factory reset.	
9sec~	Change Language, Korean ▶ English ▶ French ▶ Japanese ▶ Chinese ▶ Spanish ▶ Korean It will be applied language when you release the button.	

**⚠ Precautions for Product First Use**  
In the first product operation, press the Multi-Key button shortly after the SD card format and it switch the continuous recording.

## 6. How to use APP(Wi-Fi)

### WINYCAM Mobile APPs

- Search "WINYCAM" on Google Play and App Store in iTunes.
- OS version requirements: Android 4.4 (KitKat) or higher, iOS 10.0.2 or higher.

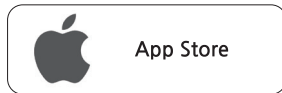

### How to connect WINYCAM Mobile APPs

- In a connectable environment, the distance range between the Dashcam and the smartphone is about 10 meters (33 feet).

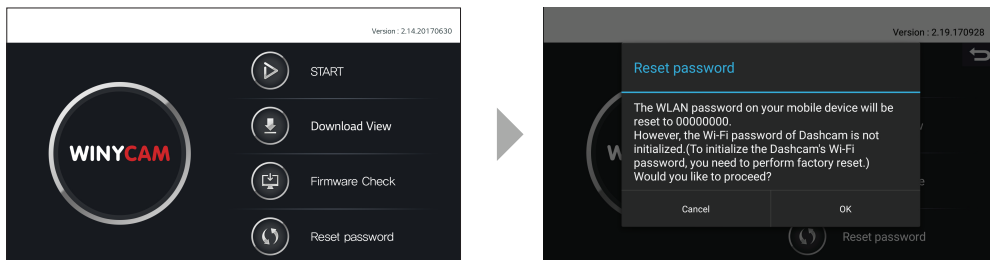

- 1) **START**: Attempts to Wi-Fi connection to the device.  
- If the device is connected to your mobile APP, "Ding dong" alerted and the menu screen is appeared in the APP.  
- For iPhone, it will enter the main menu immediately as soon as you press START button by connecting Wi-Fi manually in the setting menu.
- 2) **Reset password**: Reset the Wi-Fi password '00000000' on your phone. (Android only)
- 3) **iOS connection password**: Enter the initial password '00000000' in the Wi-Fi settings menu. (iOS only)

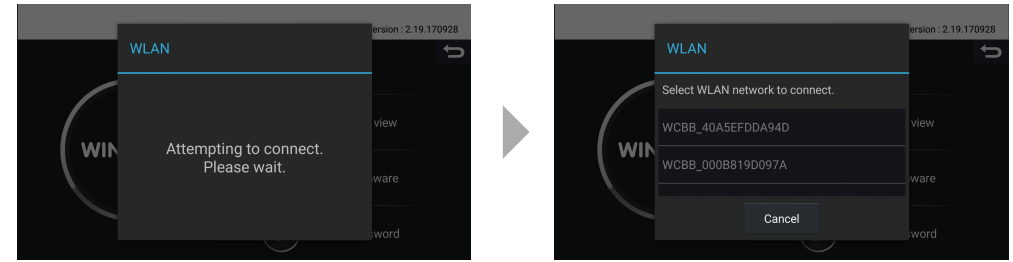

- 1) The device will be connected to APP directly if searching most recently connected AP.
- 2) APP screen will show the lists that are available to connect and user can choose the one if it search more than 2 devices
- 3) Connect Wi-Fi manually on smartphone if stop in the screen of trying connection.  
※ If the smart network switch is turned on in the selection, it should be failed to connect. Please turn off the network switch in the selection. (please noticed that setting menu is differs for each smartphone)

## 7. ADAS Set up

1. After Wi-Fi connection, go to the ADAS setup screen with the following menu. Settings -> Preferences -> ADAS Settings -> Change
2. Change the detection area to operate LDWS (over up to max.middle area)
3. After set up, please restart the device.  
The settings are applied after rebooting.

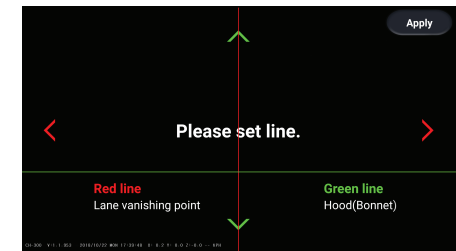

## 8. Firmware upgrade on PC

- 1) Remove the SD card from the device turn OFF
- 2) Connect to PC and back up the memory files.
- 3) Format the SD card.
- 4) Visit our website([www.winyacam.com](http://www.winyacam.com)) and download the latest firmware and copy to the SD card.
- 5) Insert the SD card to device, please power ON and the firmware will be upgraded automatically.
- 6) While upgrading, it displayed on the LCD with a voice guide.
- 7) The system will restart after the upgrade.

※User's manual and installation guide can be downloaded on our website.([www.winyacam.com](http://www.winyacam.com))

### Customer Service

Address B-110, 40, Imi-ro, Uiwang-si, Gyeonggi-do, 16006, Rep of Korea.  
Opening hour : 09:00 ~ 18:00 (Mon. ~ Fri.)  
Closed : Saturday, Sunday and Public Holiday  
If you come to customer service center, service personnel will care for the service timely and properly.  
For further information regarding customer service, please refer to [www.winyacam.com](http://www.winyacam.com)